

HIGH ROAD

CENTRE GLA - 19787sqm

KFC

SERVICE STATION

CW01

P06

P04

P05

P01

BIN WASHDOWN AREA

WILKERI DRIVE

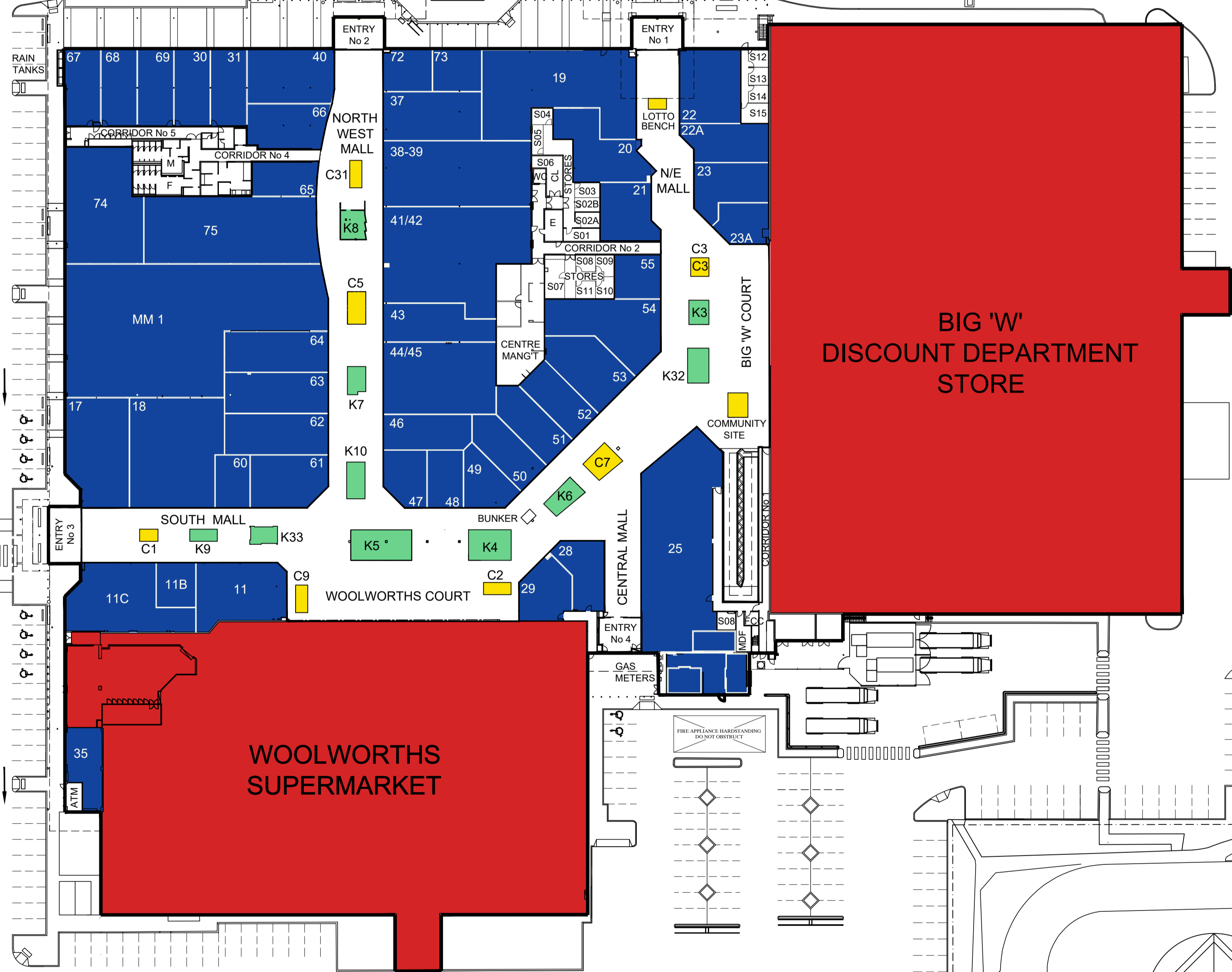

BIG 'W' DISCOUNT DEPARTMENT STORE

WOOLWORTHS SUPERMARKET

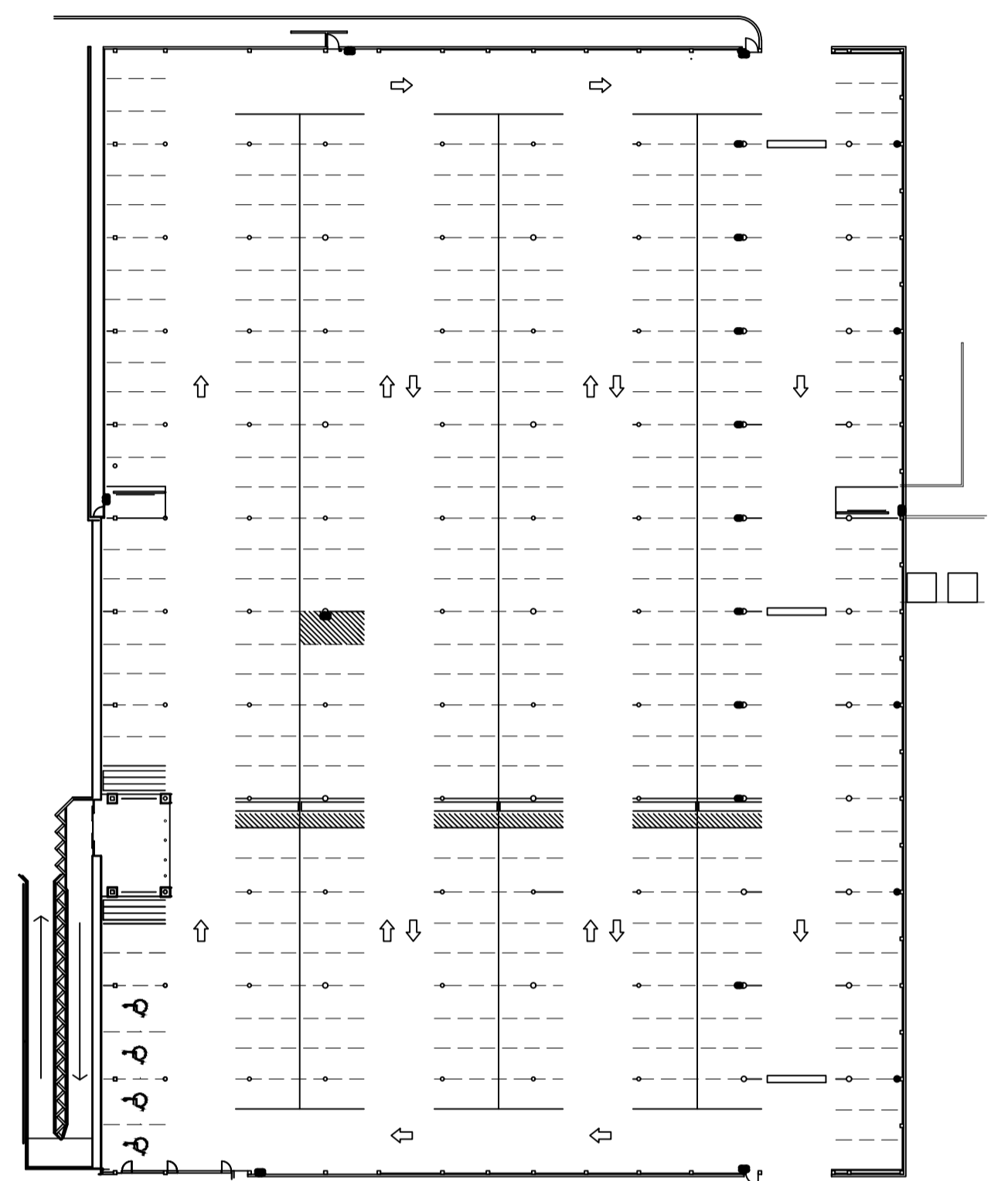

BASEMENT CARPARK

MADEIRA ROAD

GOLF ROAD

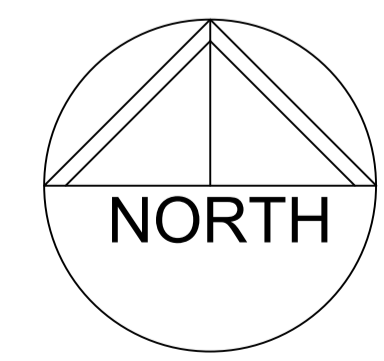

FLOOR & SITE PLAN - SCALE 1:500

11	ISSUE	JUNE 2021
10	ISSUE	APR 2021
9	ISSUE	AUG 2019
8	ISSUE	JULY 2019
7	ISSUE	MAY 2019
6	ISSUE	OCT 2018
5	ISSUE	FEB 2018
4	ISSUE	NOV 2017
3	ISSUE	OCT 2017
2	ISSUE	AUG 2017
1	ISSUE	JUNE 2017

No	REVISION	DATE
PROJECT :		
STOCKLAND RIVERTON		
CNR HIGH RD & WILKERI DRIVE RIVERTON WA		

ARCHITECT:

544 Newcastle Street
West Perth 6005
Western Australia
T: +61 (08) 9227 5353
E: admin@adcprojects.com.au

THIS SHEET TENANCY NUMBERS FLOOR & SITE PLAN			
THIS DRAWING REMAINS COPYRIGHT OF ADC PROJECTS AND SHALL NOT BE COPIED IN ANY WAY WITHOUT THE PERMISSION OF ADC PROJECTS ©2011			
DRAWN	JK	PROJECT NO	DRAWING NO
DATE	JUNE 2017	11/004	A1
SCALE	1:500 @ A1	REV 11	SHEET A1